

QUICK START GUIDE

I Brief Introduction to Cash Drawer

- 1 Line Slot**
Run the connecting wires on the box through signal wires in the slot orderly.
- 2 Signal Line**
Get drive signal from receipt printer or POS machine to open the cash drawer.
- 3 Paper Money Clip**
It is used to press down paper money to prevent it from warping.
- 4 Coin Slot Separation Sheet**
A separation sheet used for separating coins, and upon being removed, two slots will become a large slot for coins.
- 5 Paper Money Storage Slot**
The place to store paper money.
- 6 Coin Storage Slot**
The place to store coins. You can adjust the number of coin slots according to your needs.
- 7 Three-Stage Lock Head**
It supports manual opening, electric driving opening and locking functions.
- 8 Key**
The cash drawer can only be opened with key with the same number as that of the lock head.
- 9 Large Bill Storage Slot**
The lower part of the coin storage slot is large bill storage slot. After taking out the coin storage slot, you can see the large bill storage slot.

II Instructions on Unlocking the Cash Drawer

- 1 Completely Locked**
You can insert matching keys into keyhole and rotate to the completely locked position, then the cash drawer will be locked and cannot be opened.
- 2 Electric Driving Opening**
You can insert the matching key into keyhole and rotate to electric driving opening position and then install the signal line by opening the back panel baffle and plug the signal RJ12 connector into the driving device (e.g. receipt printer and POS machine).
- 3 Opening with Key**
You can insert the matching key into keyhole and rotate to manual opening position to open the cash drawer.If you cannot rotate the key to the manual opening position, please check whether the number on the key is the same as that on the lock head.

Table for Names and Content Identification of Toxic and Hazardous Substances in this Product

Part Name	Toxic or Hazardous Substances and Elements									
	Pb	Hg	Cd	Cr(VI)	PBB	PBDE	DEHP	DBP	BBP	DIBP
Circuit Board	X	○	○	○	○	○	○	○	○	○
Structural	○	○	○	○	○	○	○	○	○	○
Packaging	○	○	○	○	○	○	○	○	○	○

○： indicates that the content of the toxic and hazardous substance in all homogeneous materials of the component is below the limit specified in SJ/T 11363-2006.

X： indicates that the content of the toxic and hazardous substance in at least one homogeneous material of the component exceeds the limit stipulated in SJ/T 11363-2006. However, as for the reason, because there is no mature and replaceable technology in the industry at present.

The products that have reached or exceeded environmental protection service life should be recycled and reused according to the Regulations on Control and Management of Electronic Information Products, and should not be discarded randomly.

Basic Parameters

Nos. of Paper Money Storage Slots	4 slots for paper money and 1 slot for large bill
Nos. of Coin Storage Slots	Max 3 coin storage slots
Service Life	≥ 1 million times
Lock Head	Equipped with number, three-stage switch lock supports manual opening, electric driving opening and locking. cash drawer can only be opened with key by the same number.
Interface	RJ12
Cash Drawer Size	317mmx332mmx72mm
Cash Drawer Weight	~2.8 Kg
Driving Voltage	DC 9V-24V
Working Temperature/Humidity	0℃~45℃ / 30%~85%
Storage Temperature/Humidity	-20℃~60℃ / 10%~90%

Disclaimer

Due to product updating, some details of this document may not conform to the product. Please refer to the real product. The right of interpretation of this document belongs to our company. We reserve the right to amend this manual without prior notice.

FCC Statement

Any Changes or modifications not expressly approved by the party responsible for compliance could void the user's authority to operate the equipment. This device complies with part 15 of the FCC Rules. Operation is subject to the following two conditions:

(1) This device may not cause harmful interference, and

(2) This device must accept any interference received, including interference that may cause undesired operation.

Cash Drawer

QUICK START GUIDE
NC010

Manufacturer: Shanghai Sunmi Technology Co.,Ltd.
Address: Room 505, KIC Plaza, No.388 Song Hu Road, Yang Pu District, Shanghai, China



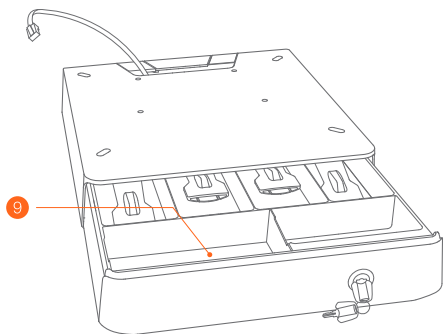
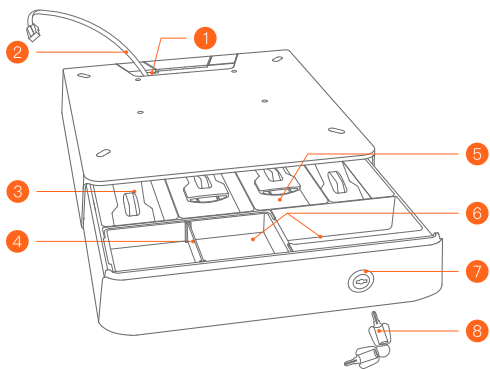

快速入门指南

I 钱箱基本介绍

1 藏线槽

将机箱上的连接线规整穿过此槽内

2 信号线

从票据打印机或POS机等设备上取得驱动信号来打开钱箱

3 纸币夹

压住纸币，防止纸币起翘

4 硬币槽分隔片

隔开放存硬币位置的挡片，硬币槽分隔片可以取出，两个硬币存放槽变为一个大的硬币存放槽

5 纸币存放槽

存放纸币的位置

6 硬币存放槽

存放硬币的位置，可根据需要自行调整硬币槽个数

7 三段式锁头

锁头上提供三种打开方式，实现打开钱箱、电驱动钱箱、锁死功能

8 钥匙

钥匙号码必须与锁头号码一致才能打开

9 大钞存放槽

硬币存放槽下方是大钞存放槽，取出硬币存放槽后露出大钞存放槽

II 钱箱开锁说明

1 完全锁死

使用配套钥匙插入钥匙孔，旋转到完全锁死位置，钱箱将锁死无法打开。

2 电驱动打开

使用配套钥匙插入钥匙孔，旋转到电驱动打开位置，接着就可以开始安装信号线。打开后面板挡板，将信号线RJ12接头插上驱动设备（如：票据打印机、POS机等）。

3 钥匙打开

使用配套钥匙插入钥匙孔，旋转到手工打开位置，即可打开钱箱。如果钥匙无法拧到手工打开位置，请检查钥匙上面的号码与锁头是否一致。

本产品有毒有害物质名称及含量标识表

部件名称	有毒有害物质或元素					
	铅 (Pb)	汞 (Hg)	镉 (Cd)	六价铬 (Cr(VI))	多溴联苯 (PBB)	多溴二苯醚 (PBDE)
电路板组件	×	○	○	○	○	○
结构件	○	○	○	○	○	○
包装件	○	○	○	○	○	○

○：表示该有毒有害物质在该部件所有均质材料中的含量均在SJ/T11363-2006规定的限量要求以下。

×：表示该有毒有害物质至少在该部件的某一均质材料中的含量超出SJ/T11363-2006规定的限量要求；但是上表中打“×”的部件，其含量超出是因为目前业界还没有成熟的可替代的技术。

对达到或超出环保使用年限的产品，应依据《电子信息产品控制管理办法》规定进行回收再利用，不应随意丢弃。

基本参数

纸币存放槽个数	4纸币格、1大钞格
硬币存放槽个数	MAX3个硬币存放槽
使用寿命	≥100万次
锁头	三段式开关锁，支持手工打开、电驱动打开、锁死功能。并且配备有号码，只有号码相符的钥匙才可以打开钱箱
接口	RJ12
钱箱尺寸	317mmx332mmx72mm
钱箱重量	~2.8 Kg
驱动电压	DC 9V~24V
工作温度/湿度	0℃~45℃ / 30%~85%
存储温度/湿度	-20℃~60℃ / 10%~90%

免责声明

由于产品的更新，此文档的某些细节可能与产品不符，请以实物为准，此文档的解释权归本公司。保留不预先通知的情况下，修改本说明书的权利。

产品保修卡

产品保修卡

产品名称：_____
产品型号：_____
产品编号：_____
购买日期：_____
保修期限：自购买之日起， 我公司提供 ____ 天保修服务。

联系方式：_____
· 公司地址：_____
· 联系电话：_____

以下情况恕不提供免费保修：

- 未经允许擅自拆卸修理的产品。
- 产品条码、易碎贴破损及保修卡涂改、残缺的。
- 未按照说明书的要求操作设备所引起的故障。
- 因进水或跌落而造成的故障、划伤或破损的人为损坏。
- 因不可抗拒因素造成的故障或损坏。
- 保修期限外。

产品合格证

产品合格证

检验合格

制造商：上海商米科技集团股份有限公司
地 址：上海市杨浦区淞沪路388号创智天地7号楼505室

技术参数

尺寸：90*150mm

材质：128g哑粉

印刷：70%黑+2专；双面印刷

工艺：过油，对折再对折（橙色页为封面）

环保要求：RoHS



Pantone 165C



Pantone Orange 021C