



13119046-00

## T2s LITE

POS User Manual

## Three options for sub screen of intelligent POS machine



15.6" main screen only  
(L571)



15.6" main screen+10.1"  
customer screen  
(L572)



15.6" main screen+15.6"  
customer screen  
(L573)

## Quick Installation Guide

"Take main screen as sample"



1. Rotate the display to horizontal

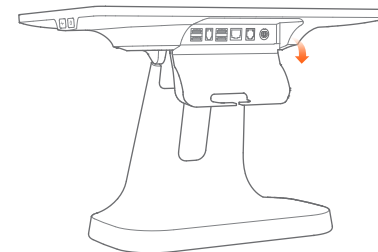

2. Open the port cover

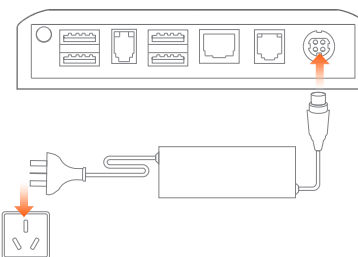

3. Connect the power interface of the adapter to the power port at the bottom of the mainframe. And insert the other side of the adapter to electric supply sockets

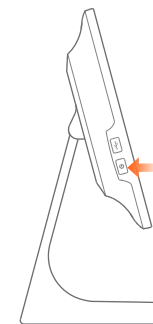

4. Press the power button for two seconds to turn on

# Product Introduction

"Take main screen as sample"

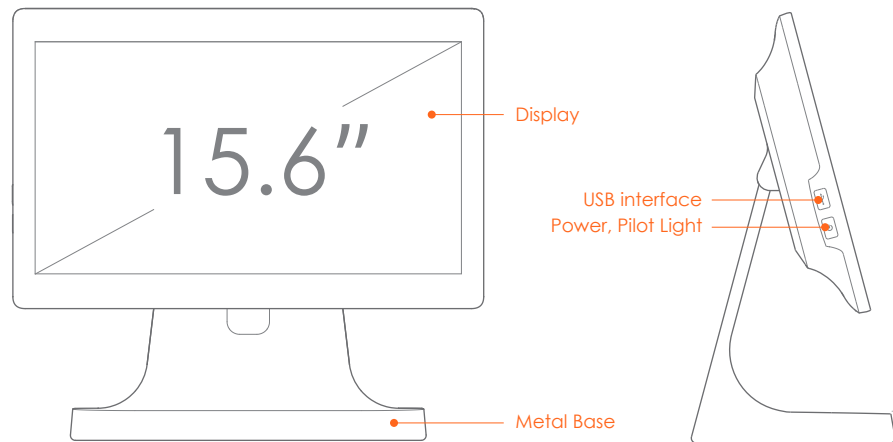

## Power

In the state of power off, a short press turns on the POS machine.

When powered on, press on the power button for two or three seconds to choose power off or restart.

If the system is frozen, press the power button for 11 seconds to power off.

## Pilot Light

The light will be blue when the power is on. When the power is off, the light is off.

## USB Interface

For external keyboard, mouse and USB drive.

## Display

For the touch screen used by the operator.

## Metal Base

For supporting the display when put on the desktop.

Able to be replaced with the VESA suspension bracket.

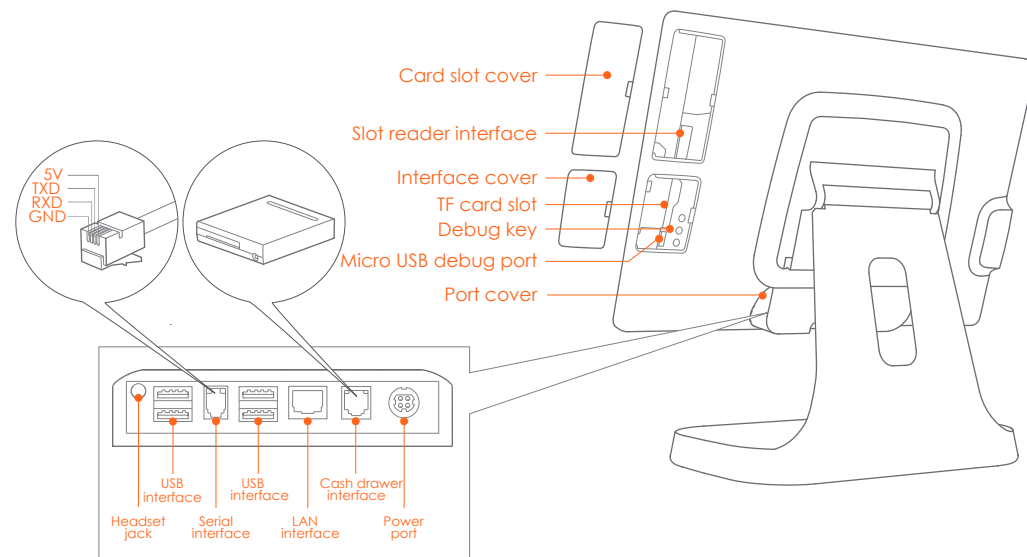

## Slot reader interface

For external MSR/NFC POS

Card slot is an optional part which may not be available in all configurations.

## TF card slot

For external TF card.

## Micro USB debug port, debug key

For device debugging only.

## Cash drawer interface

For external cash drawer with 120ms electric pulse output. No continuous power is supplied. This system only supports 24V/1A cash drawers. Connecting a 12V drawer may result in hardware failure.

# Installation Steps for the VESA Bracket

"Single screen configuration only"

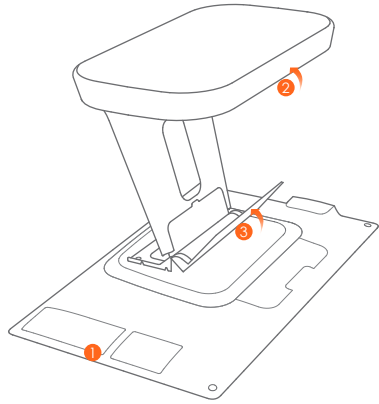

## Remove the base

1. Put the display flat on the desktop with its face down.
2. Rotate the metal base to vertical.
3. Remove the lower cover of the bracket.

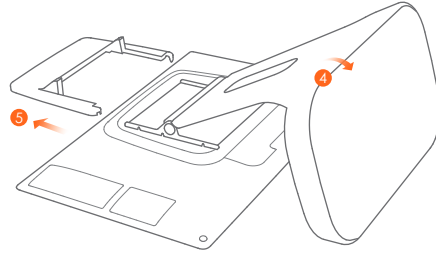

## Remove the base

4. Rotate the metal base to horizontal.
5. Remove the upper cover of the bracket.

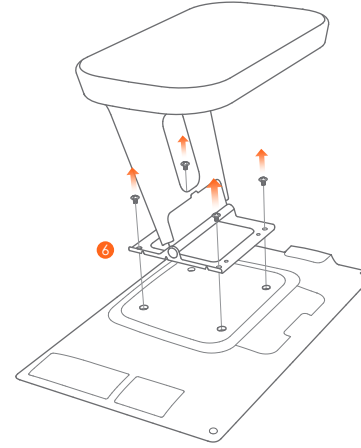

## Remove the base

6. Unscrew the four M4 screws with a screwdriver and complete the removal of base.

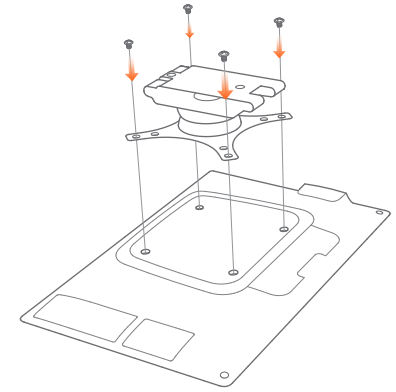

## Install VESA accessories

1. Place the VESA bracket aligning the four screw holes according to directions.
2. Use the four M4 screws removed from the base to fix the VESA bracket.
3. Install the bracket on the wall or desk in accordance with VESA bracket instructions to complete the installation.

Note: This machine only supports the installation for VESA MIS-D (100×100mm) suspension bracket. The VESA bracket is an optional accessory which needs to be purchased by the user.

## Minimal Settings

Only a few steps to turn on the intelligent business equipment.

- 1 Press the power button and the screen will power on. Enter the first start-up screen and follow the prompts. Two options for Internet access are available.
- 2 Wi-Fi setting.
  - Press [Setting] and start WLAN. Enter the searching interface of WLAN, waiting for WLAN network available;
  - Click on the WLAN to be connected. A password is required for access if an encrypted network is chosen.
- 3 Setting of LAN

### How to download/use the application

This POS machine is suitable for cashier environment of business customers of different industries including Chinese and Western foodservice industry, exclusive department store, convenience store, the banking service industry, consulting station, interactive multimedia and advertisement broadcast system, etc. Relevant apps can be scanned, downloaded and installed in the application store with access to the internet.

Please read the built-in Help APP for more help.

## Basic Specifications

Operating system	Android 9.0
Processor	Qualcomm snapdragon Qcta-core processor
Display resolution	15.6'' resolution HD 1920 x 1080
Storage	32GB ROM + 3GB RAM or 64GB ROM + 4GB RAM
Touch screen	Multi-touch capacitive display
Wi-Fi	Support 802.11b/g/n/AC 2.4GHz/5GHz
Bluetooth	Support Bluetooth 3.0/4.0/5.0 and iBeacon
Loudspeaker	Single 1.2W voice reaches 90db
External interface	5 x USB Type A interfaces, 1x RJ11 serial interface, 1 x RJ12 24V cash drawer interface, 1x RJ45 LAN interface, 1 x headset jack, 1x power port, 1x Micro-USB debug interface
External storage card	MicroSD (TF), 64G maximum
VESA(limited main screen only)	In accordance with VESA MIS-D 100×100mm Standard
Item dimension	H 35cm × W 38cm × T 17cm
AC adapter	Input:AC 100~240V,50/60Hz,1.5A      Output:DC 24V,1.5A

### Specification of 15.6" customer display (optional)

Display resolution	15.6'' resolution HD 1920 x 1080
Touch screen	Multi-touch capacitive display

### Specification of 10.1" customer display (optional)

Display resolution	10.1'' resolution HD 1024 x 600
Touch screen	Multi-touch capacitive display

Configurations and parameters listed in this page are indicative and actual products on the market shall prevail.

# Precautions

## Warning

- Please insert the AC plug into the AC outlet according to the identifying input on the power adapter;
- It is prohibited to use the device in any places with potential explosive gases;
- Nonprofessionals shall not open the power adapter anyhow so as to avoid dangers;
- The device is a Grade A product. In living environment, the product may cause radio interference. Therefore, users may be required to take practical measures against the interference.
- About the battery replacement:
  1. It may cause explosion with wrong type battery
  2. Old battery which is replaced should be handled by repair man, do not put it in fire!
- Adapter shall be installed near the equipment and shall be easily accessible.
- The operating temperature of the device between 0°C to 45°C.
- The device complies with RF specifications when the device used at 20cm from your body.
- This product can be used across EU member states.

## Recommendation

- Do not use the device near water or in humid environment. Keep liquid from falling onto the terminal;
- Do not use the device in extremely cold and hot environment, e.g. around fire or lighted cigarettes;
- Do not smash, throw or bend the device;
- Use the device in clean and dustfree environment as much as possible and keep small items from falling into the terminal;
- Do not use it near medical devices unless permitted.

## Important Safety Instructions

- Avoid installing or using during thunder and lightning, otherwise lightning stroke may occur;
- Cut off the power immediately if there is abnormal smell, overheating or smog!

## Statement

The company is not responsible for the following behaviors:

- Damages caused by using and maintaining the device without following the User Guide;
- Damages or problems caused by selection of objects or Consumables (products which are not the initial ones provided or recognized by the company).  
In this case, the company will not undertake any responsibility.
- No one is entitled to modify or change the product unless permitted by the company.

## Disclaimer

Discrepancies between the product and the file concerning details may arise due to product updates. Please be subject to the material object. The company reserves the right to interpret the file and the right to revise this manual without prior notices.

Please make sure the temperature for adapter will be from -10 °C to 40 °C.

Please make sure the temperature for device will be from -10 °C to 40 °C.

# Name and content of toxic and harmful substances contained in this product are shown in the following table

Name of parts	Toxic and harmful substances and elements					
	(Pb)	(Hg)	(Cd)	(Cr(VI))	(PBB)	(PBDE)
Circuit board	×	○	○	○	○	○
Shell	○	○	○	○	○	○

○ :It indicates that the content of toxic and harmful substances in all homogeneous materials of this part is below the limit specified in SJ/T11363-2006.

× :It indicates that the content of toxic and harmful substances is higher than the limit specified in SJ/T11363-2006 in at least one homogeneous material of this part; however, the reason why the toxic substance of that part exceeds the limit is that there is no applicable material to replace it currently.

For products that have reached or passed the service years for environmental protection, they should be recycled according to Measures for Control and Management of Electronic Information Products and should not be thrown away at will.

## Package content

- ☑ 1× main machine
- ☑ 1× user manual
- ☑ 1× power adapter

## Manufacture

Room 505, KIC Plaza, No.388 Song Hu Road, Yang Pu District, Shanghai, China

## EU Regulatory Conformance

Hereby, Shanghai Sunmi Technology Co., Ltd. declares that the radio equipment type is in compliance with Directive 2014/53/EU.

The full text of the EU declaration of conformity is available at the following internet address: [www.sunmi.com](http://www.sunmi.com)



**Notice:** Observe the national local regulations in the location where the device is to be used. This device may be restricted for use in some or all member states of the European Union (EU). Adapter shall be installed near the equipment and shall be easily accessible. The operating temperature of the device between 0°C to 45°C. The device complies with RF specifications when the device is used at 20cm from your body. This product can be used across EU member states.

## FCC Regulations:

This device complies with part 15 of the FCC Rules. Operation is subject to the condition that this device does not cause harmful interference.

This device has been tested and found to comply with the limits for a Class B digital device, pursuant to Part 15 of the FCC Rules. These limits are designed to provide reasonable protection against harmful interference in a residential installation. This equipment generates, uses and can radiate radio frequency energy and, if not installed and used in accordance with the instructions, may cause harmful interference to radio communications. However, there is no guarantee that interference will not occur in a particular installation. If this equipment does cause harmful interference to radio or television reception, which can be determined by turning the equipment off and on, the user is encouraged to try to correct the interference by one or more of the following measures:

- Reorient or relocate the receiving antenna.
- Increase the separation between the equipment and receiver.
- Connect the equipment into an outlet on a circuit different from that to which the receiver is connected.
- Consult the dealer or an experienced radio/TV technician for help.

**Caution:** Changes or modifications not expressly approved by the party responsible for compliance could void the user's authority to operate the equipment.

## Technical features and characteristics

the product includes the following features and characteristics:

BT	
Operation Frequency	2402MHz-2480MHz
Transmitted	2dBm±1dBm
BLE	
Operation Frequency	2402MHz-2480MHz
Transmitted	1dBm±1dBm
WIFI	
Operation Frequency	2412MHz-2462MHz
Transmitted	17dBm±1dBm